

For furnaces, heaters, combustors and reformers in the petrochemical industry. The REL® (Refrex®-Expanchor®-Lining) system is a combination of a flexible, almost dust tight, high temperature and erosion resistant fabric (Refrex®) and a simple, easy to apply anchoring system. (Expanchor®).

Roofs (and sometimes also walls) of cracking furnaces, heaters and reformers in the Petrochem are regularly insulated with a high temperature low thermal mass lining (stackbond/modules).

However, after a certain time, you can be faced with the following problems:

- Shrinkage joints
- Erosion
- Hot spots
- Reduced insulation values
- Higher gas/fuel consumption

The solution to avoid this, is our Refrex® Expanchor® Lining System.

Ceramic fixing devices Expanchors® are pressed through Refrex® fabric into fibre lining and injected by Insulmoud for durable fixing. Easy installing of pre-fabricated Refrex® sheets, fixed into fibre lining by Expanchor®. For existing lowthermal mass linings, the Insulcon Group (Insulcon and Keramab) has developed the Refrex® Expanchor® Lining system, which has been sucessfully used since 1996.

Advantages:

- Reflection of 60% of the radiation heat
- Reduction of maintenance costs
- No further eroding of existing fibre lining
- Can be installed over existing fibre lining

CONTACT

INSULCON B.V. – The Netherlands
+31 (0) 167 565750
info@insulcon.com

KERAMAB N.V. – Belgium
+32 (0) 3 711.02.78
sales@keramab.com

INSULCON GMBH - Germany
+49 (0) 2131 408548-0
insulcongmbh@insulcon.com

INSULCON PROJECTS S.A. - Switzerland
+41 (0)91 911739
infos@insulcon.com



Refrex® New Lining – Refrex® Expanchor® Lining PetroChem Industry

LEADER IN HIGH TEMPERATURE SOLUTIONS



It is an easy upgrade/improvement of your existing low thermal mass lining, without a complete renewal!
With our patented Expanchor® our Refrex® 1220 / 1420 fabric can be easily attached to the existing low thermal mass lining, depending the condition of the existing low thermal mass lining.

Applications with the REL-System to prevent further problems are:

- Repair of eroded areas and corners of existing LTM lining at the roof / wall.
- Upgrade of an existing LTM lining.

Typical design Refrex® Expanchor® Lining system:

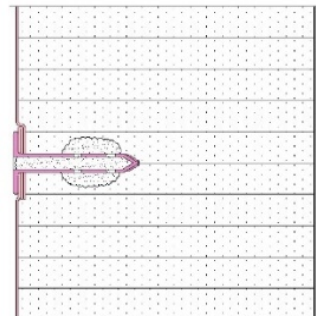

CONTACT

INSULCON B.V. – The Netherlands
+31 (0) 167 565750
info@insulcon.com

KERAMAB N.V. – Belgium
+32 (0) 3 711.02.78
sales@keramab.com

INSULCON GMBH - Germany
+49 (0) 2131 408548-0
insulcongmbh@insulcon.com

INSULCON PROJECTS S.A. - Switzerland
+41 (0)91 911739
infos@insulcon.com

In case the complete lining needs to be renewed, our Refrex® New Lining is the best option.



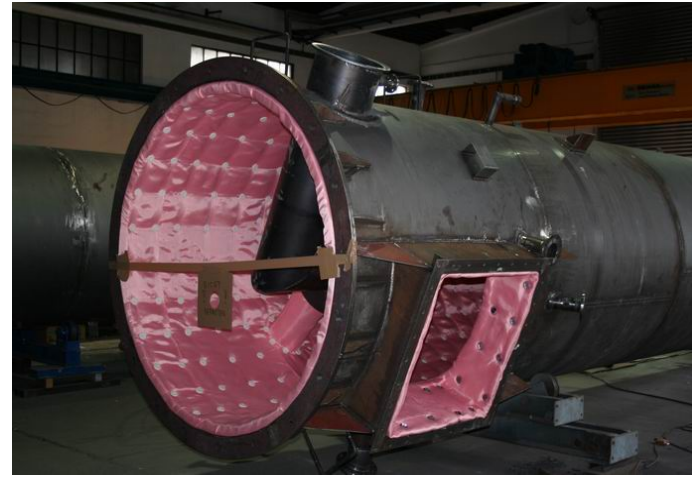

This combination of a layered low thermal mass lining and Refrex® 1220/1420 fabric can be used when a roof needs to be completely renewed.

Typical design Refrex® New Lining system:

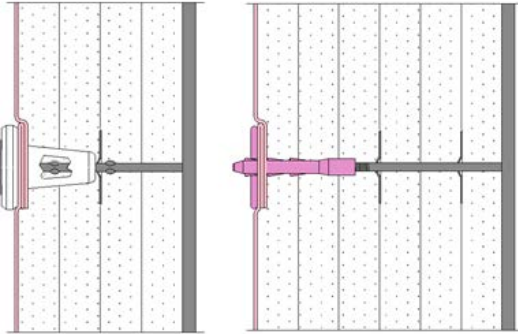

Another application of the **Refrex® New Lining system** is a thin wall insulation in combustors.

Environmental regulations forces refineries in Europe to incinerate carbon-oxide gasses, released during loading of vessels with gasoline or diesel at the refinery side.

These gasses should be incinerated environmental friendly, in special combustor units.



Complete combustor unit.

CONTACT

INSULCON B.V. – The Netherlands
+31 (0) 167 565750
info@insulcon.com

KERAMAB N.V. – Belgium
+32 (0) 3 711.02.78
sales@keramab.com

INSULCON GMBH - Germany
+49 (0) 2131 408548-0
insulcongmbh@insulcon.com

INSULCON PROJECTS S.A. - Switzerland
+41 (0)91 911739
infos@insulcon.com

As most of these processes are discontinuous, a traditional refractory lining, like castable or bricks is not durable due to the high level of damaging (cracking) caused by thermal shock.

For these kind of combustors (and open air flares), Insulcon B.V. developed a Low Thermal Mass, erosion and water resistant “bio soluble” lining, consisting of a 50 mm Isofrax® back-up lining, finished with a Refrex® 1420 fabric. (The units are completely pre lined in a steelshop and accordingly transported to their final location at the refinery.